

# 8. Schematic Diagrams

## 8-1 CP1 (CAA CCD AFE & DRIVER)

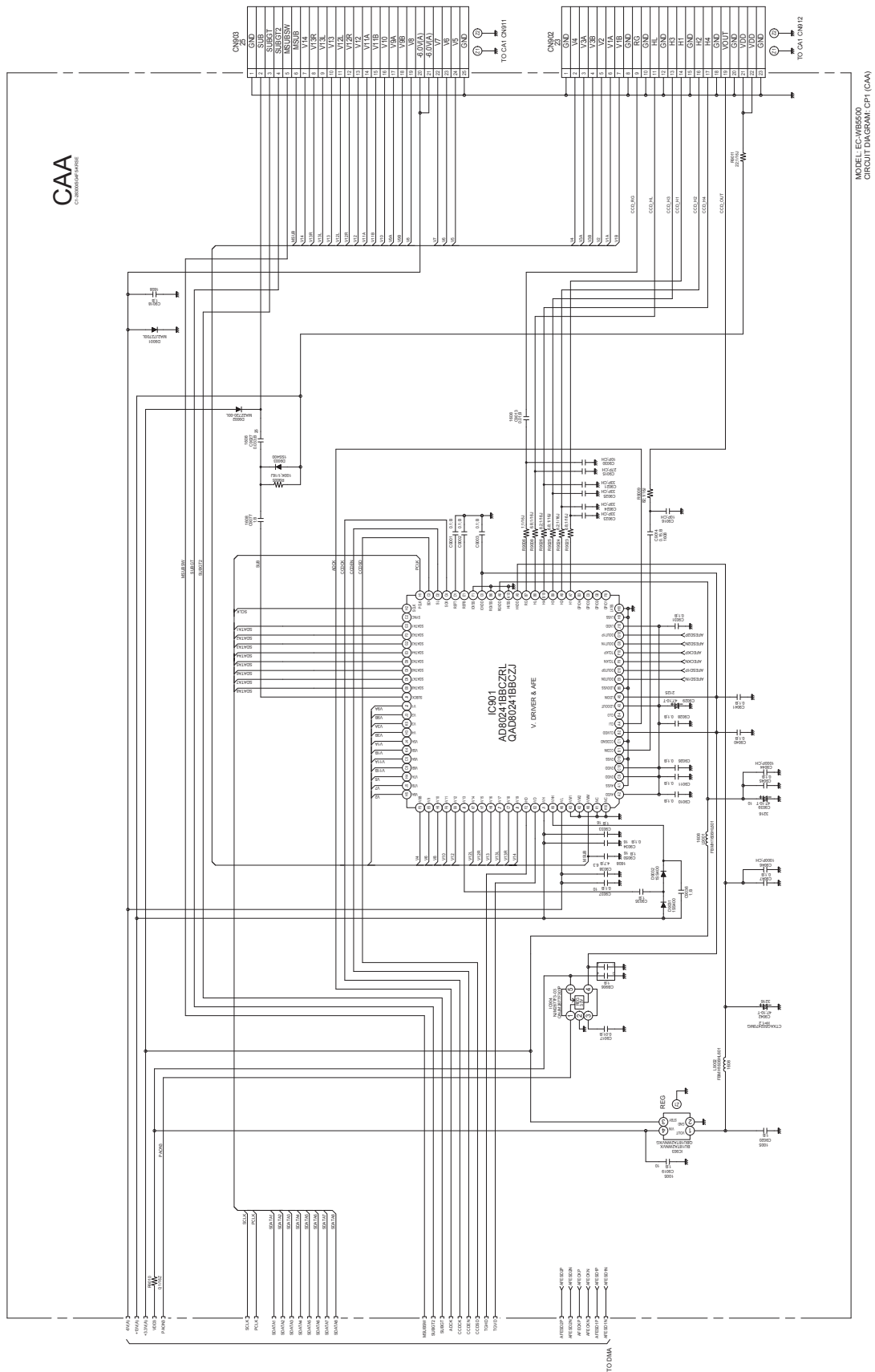

# 8-2 CP1 (DMA MAIN LCD EVF LENS)

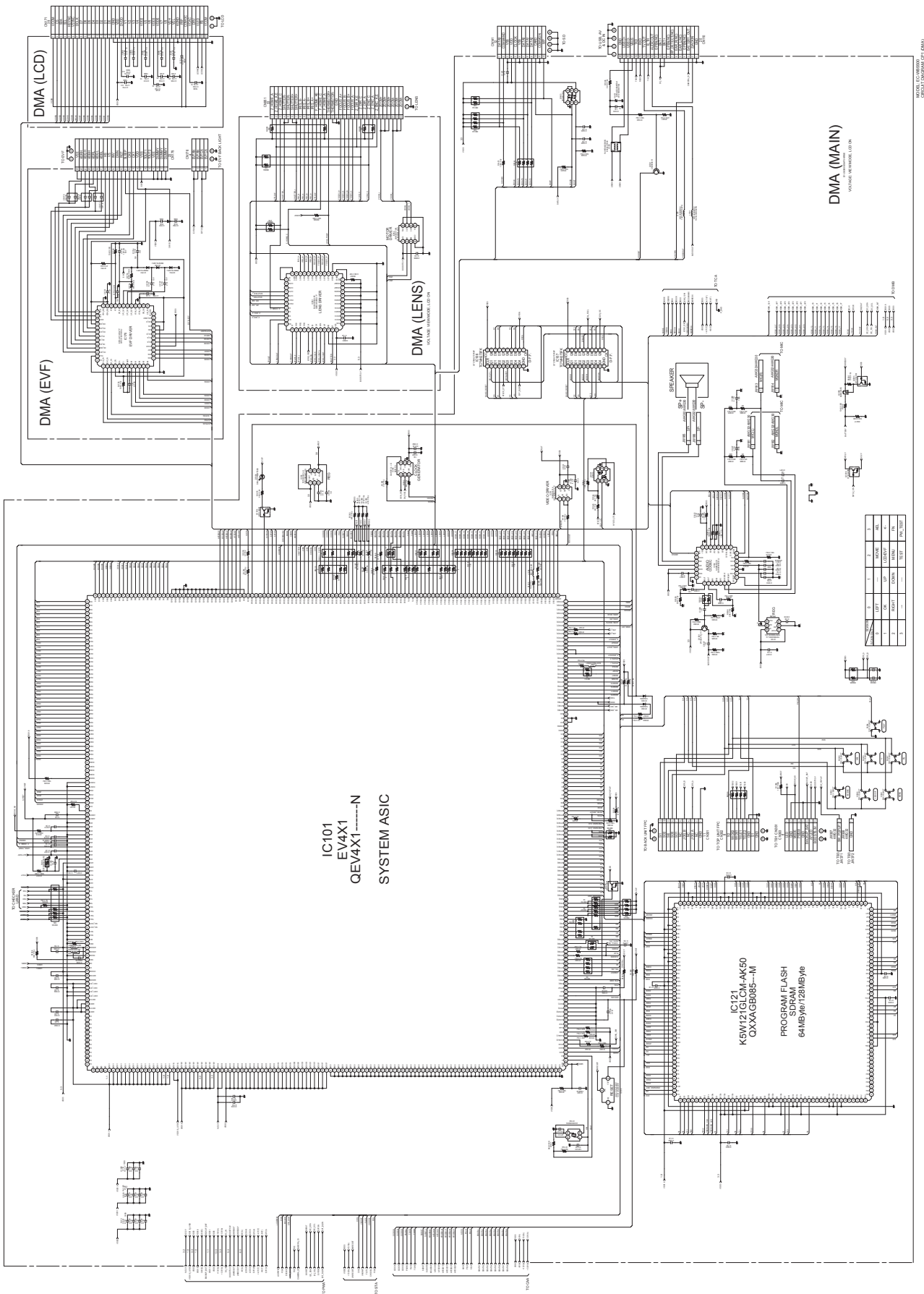

# 8-3 CP1 (DMB)

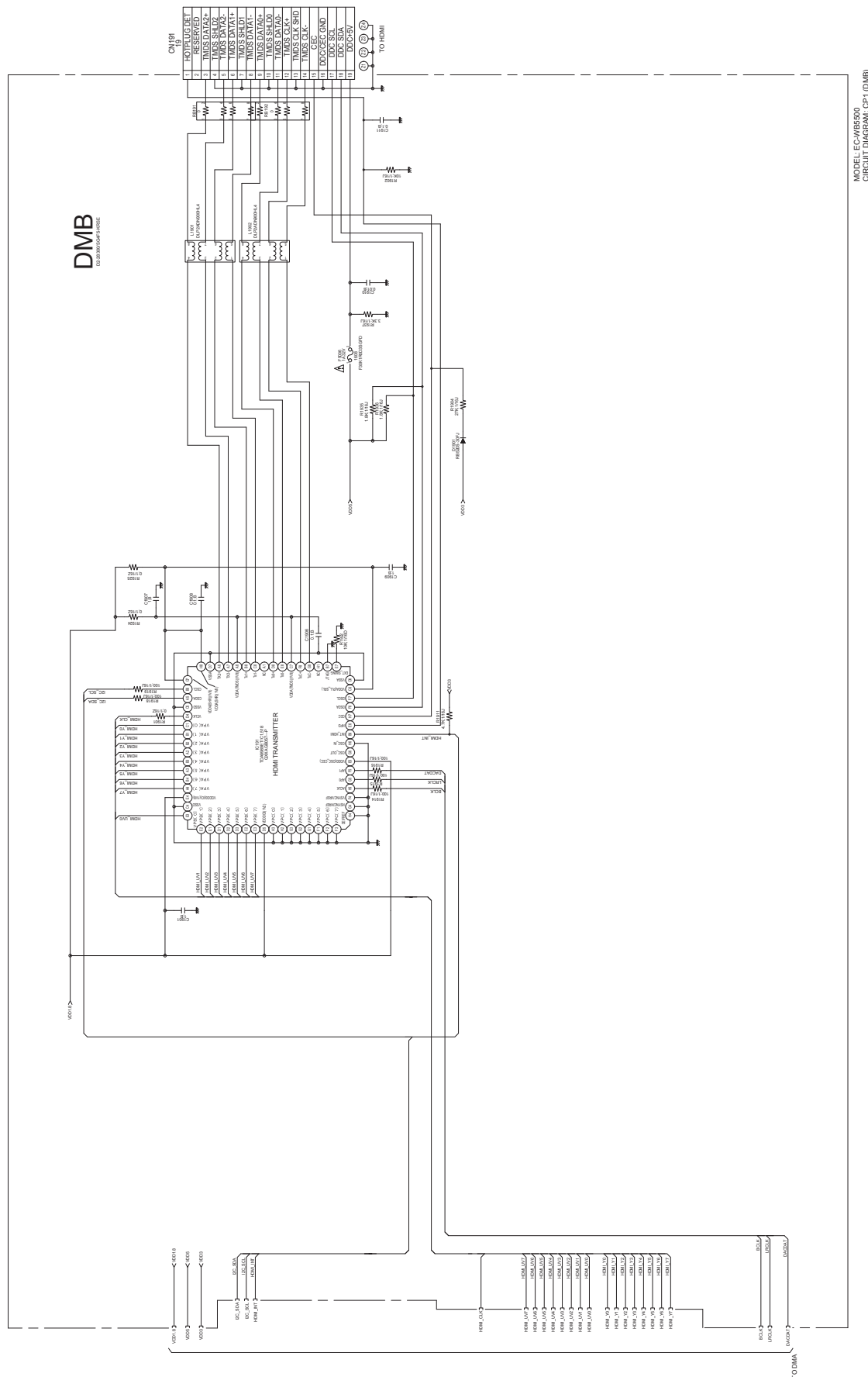

# 8-4 CP1 (PWA POWER)

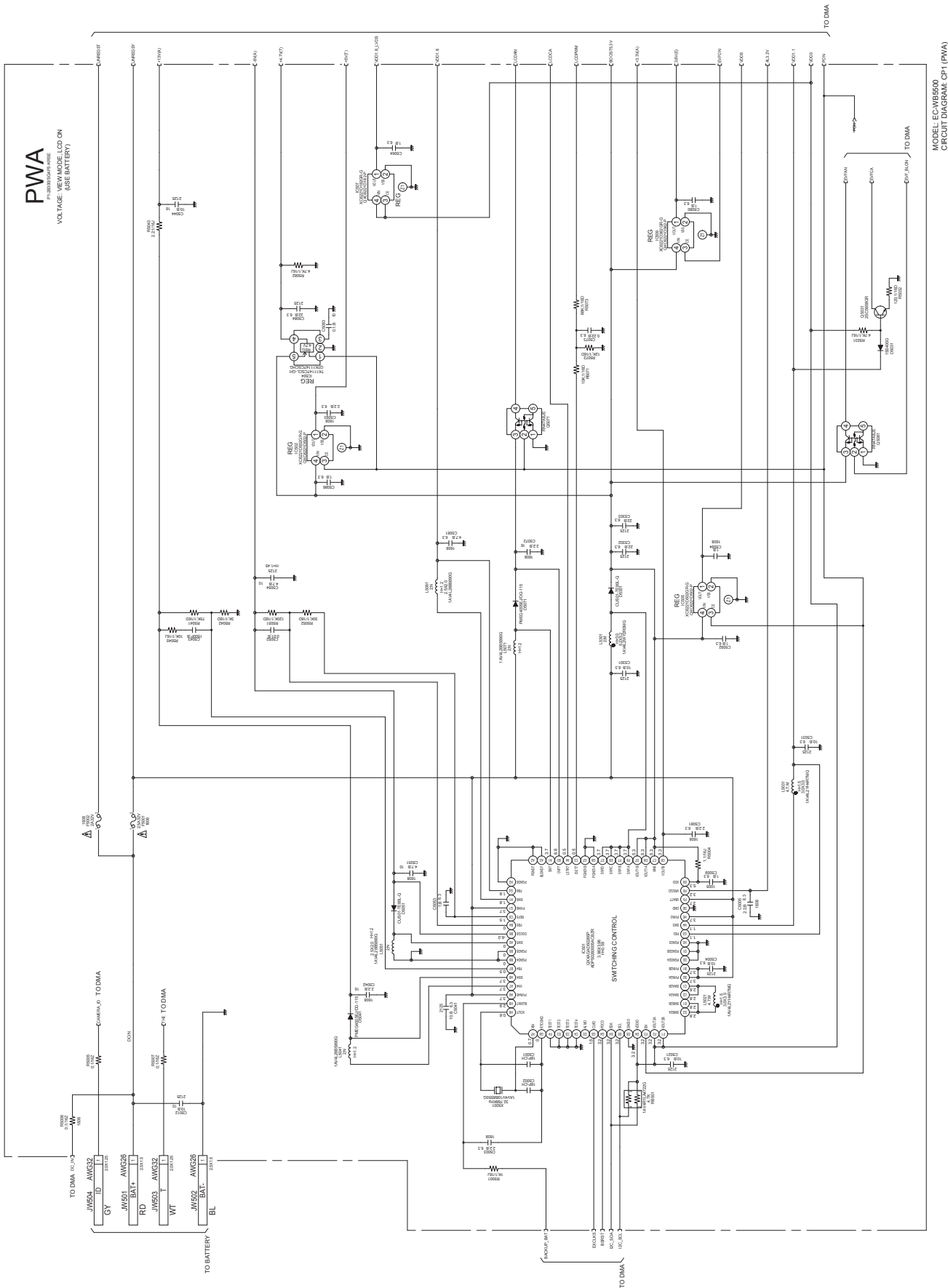

# 8-5 CP1 (STA STROBE)

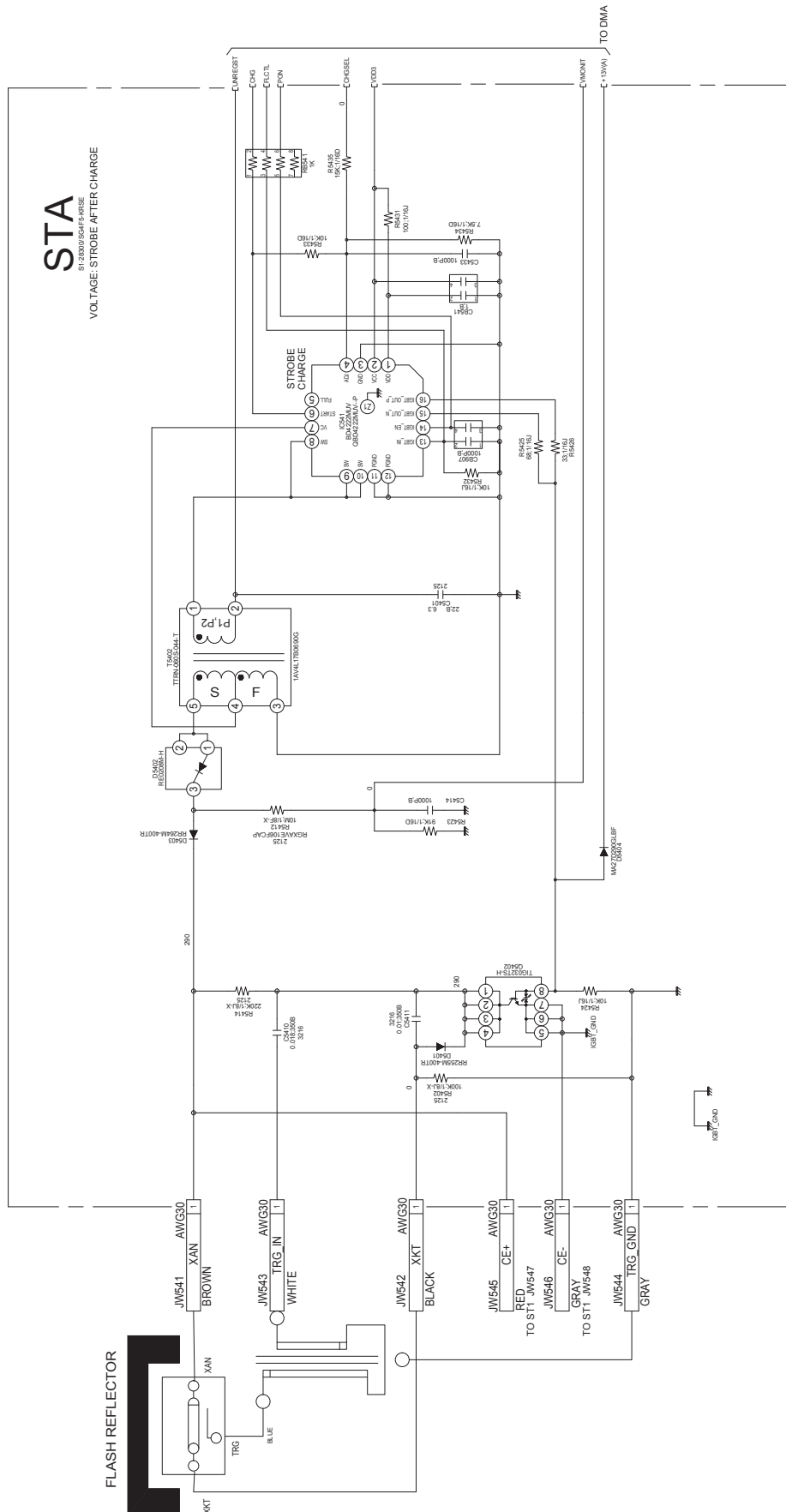

MODEL: EC-WB5500  
CIRCUIT DIAGRAM: CP1 (STA)

# 8-6 CP1 (TCA IMAGE STABILIZER)

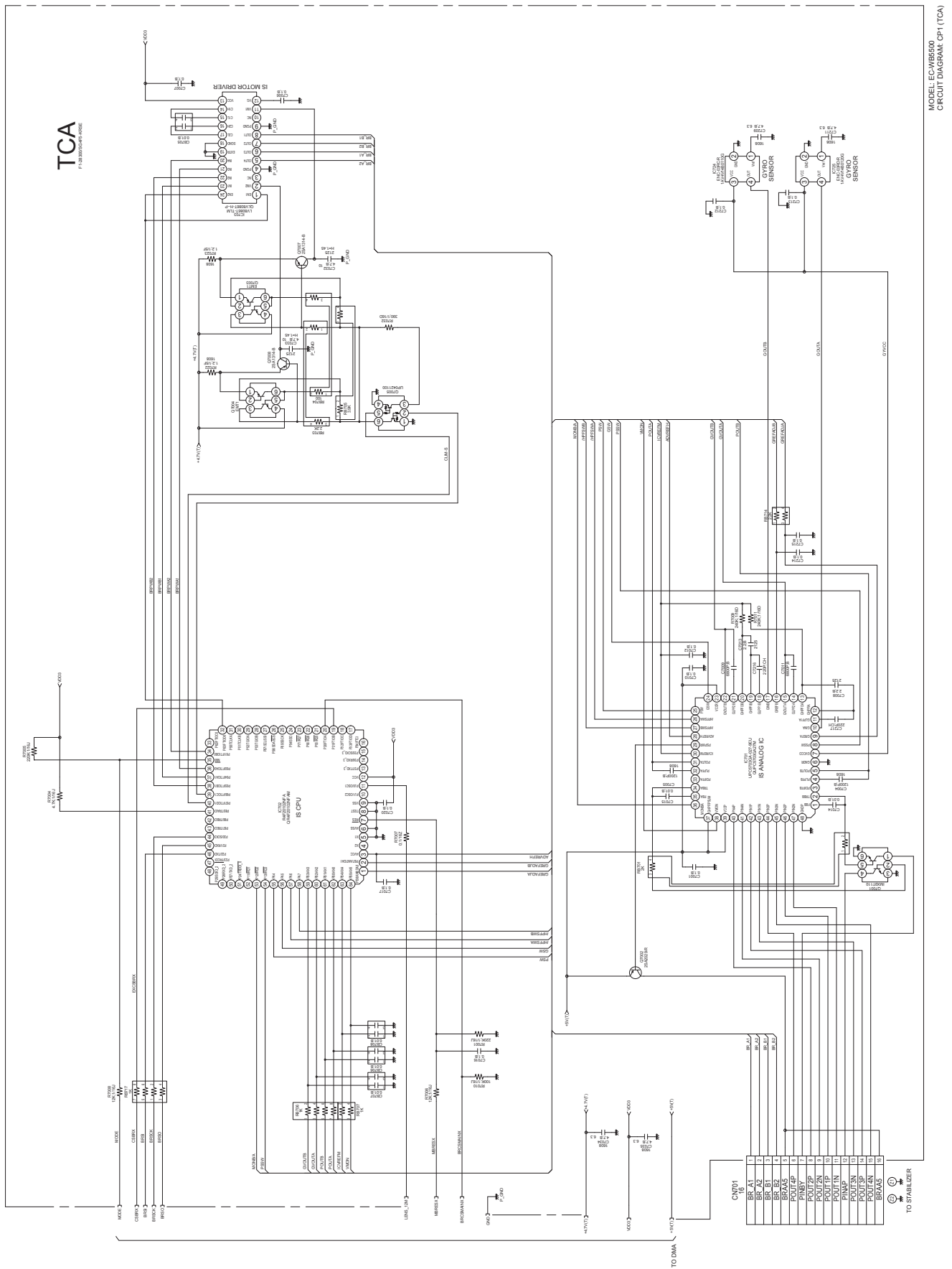

# 8-7 CA1 (CCD)

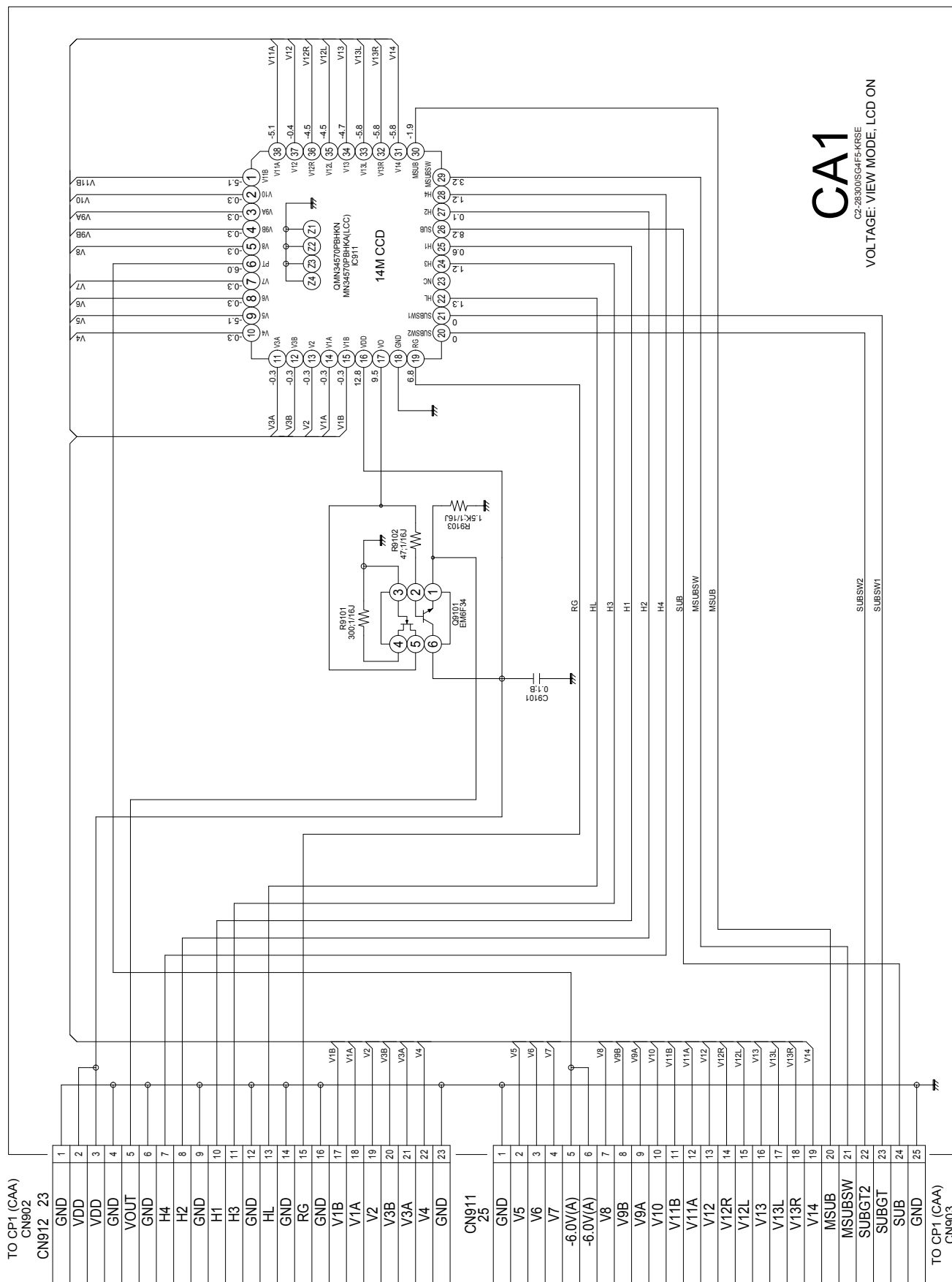

MODEL: EC-WB5500  
CIRCUIT DIAGRAM: CA1

# 8-8 ST1 (STROBE CAPACITOR)

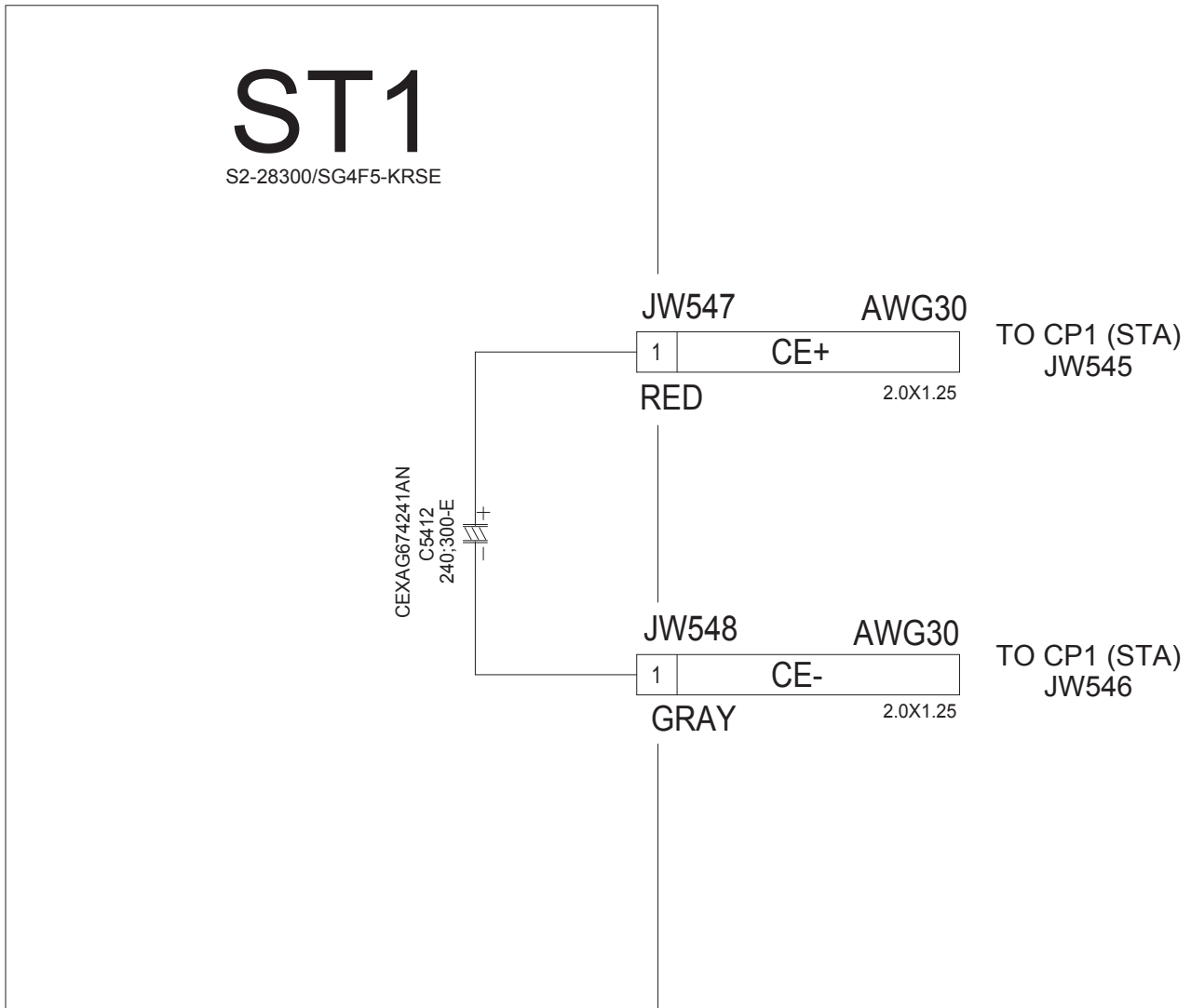

MODEL: EC-WB5500  
CIRCUIT DIAGRAM: ST1



8-9 TB1

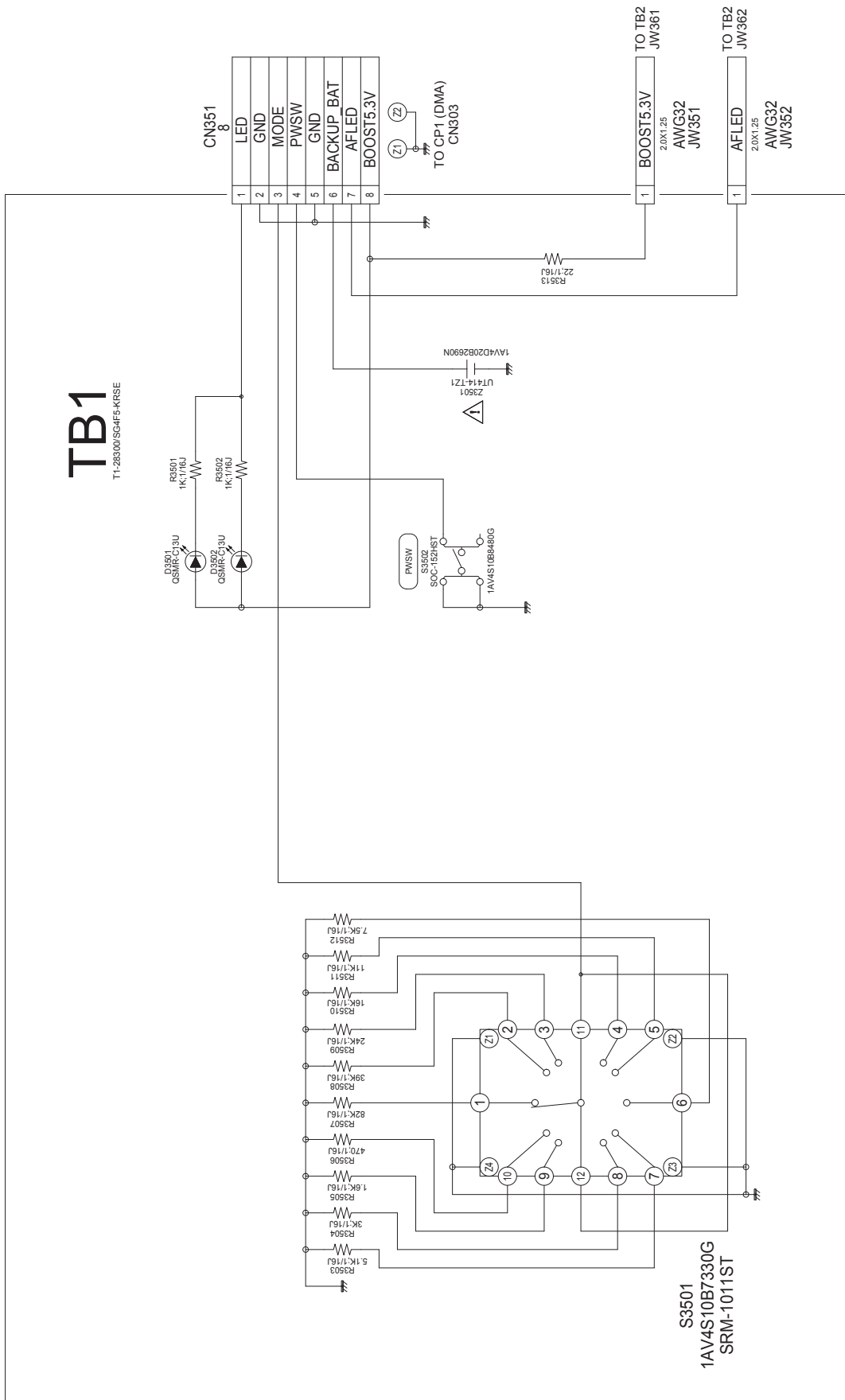

MODEL: EC-WB5500  
CIRCUIT DIAGRAM: TB1

# 8-10 TB2

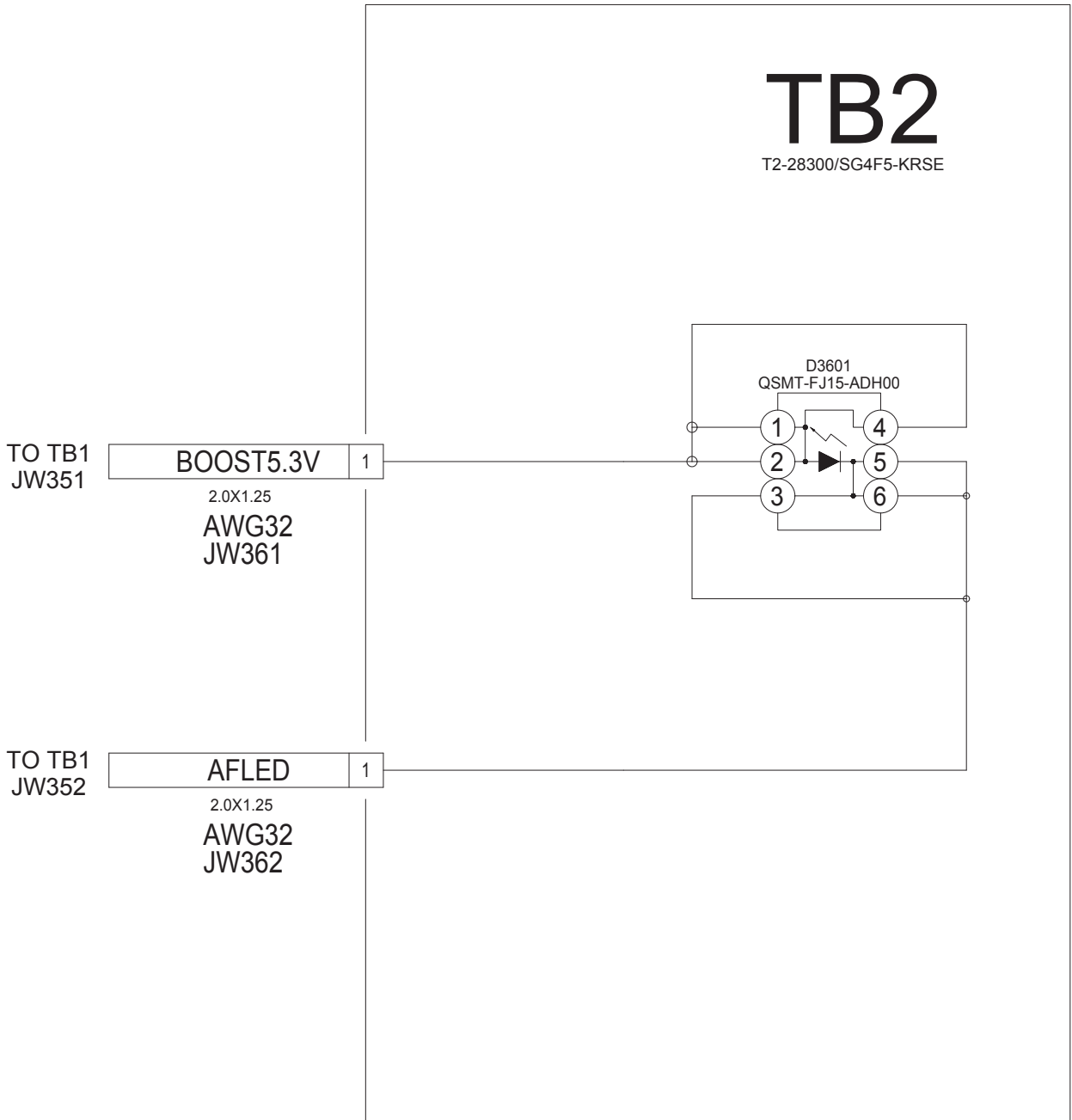

MODEL: EC-WB5500  
CIRCUIT DIAGRAM: TB2

**8-11 TB3**

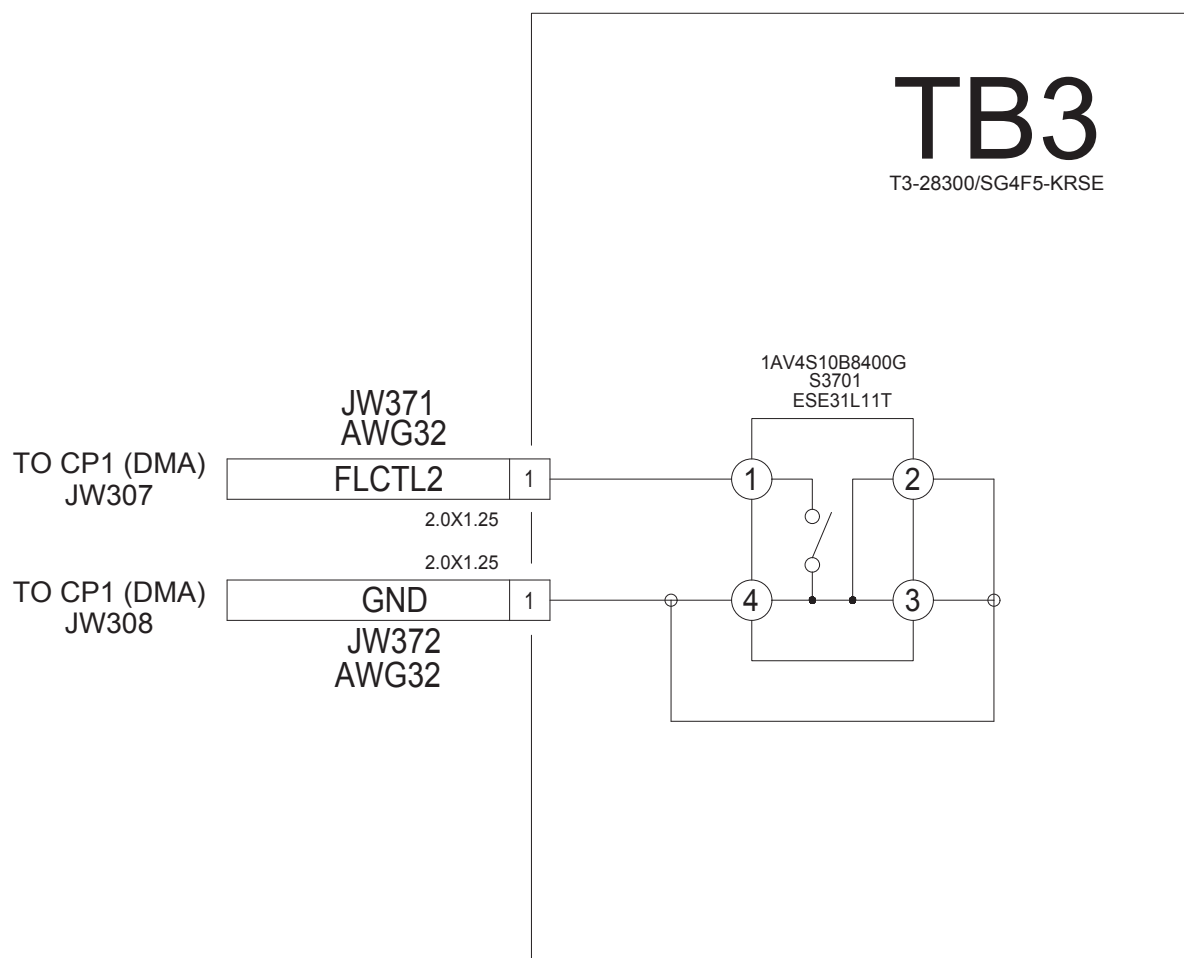

MODEL: EC-WB5500  
CIRCUIT DIAGRAM: TB3

# 8-12 CP1 (OVERALL WIRING)

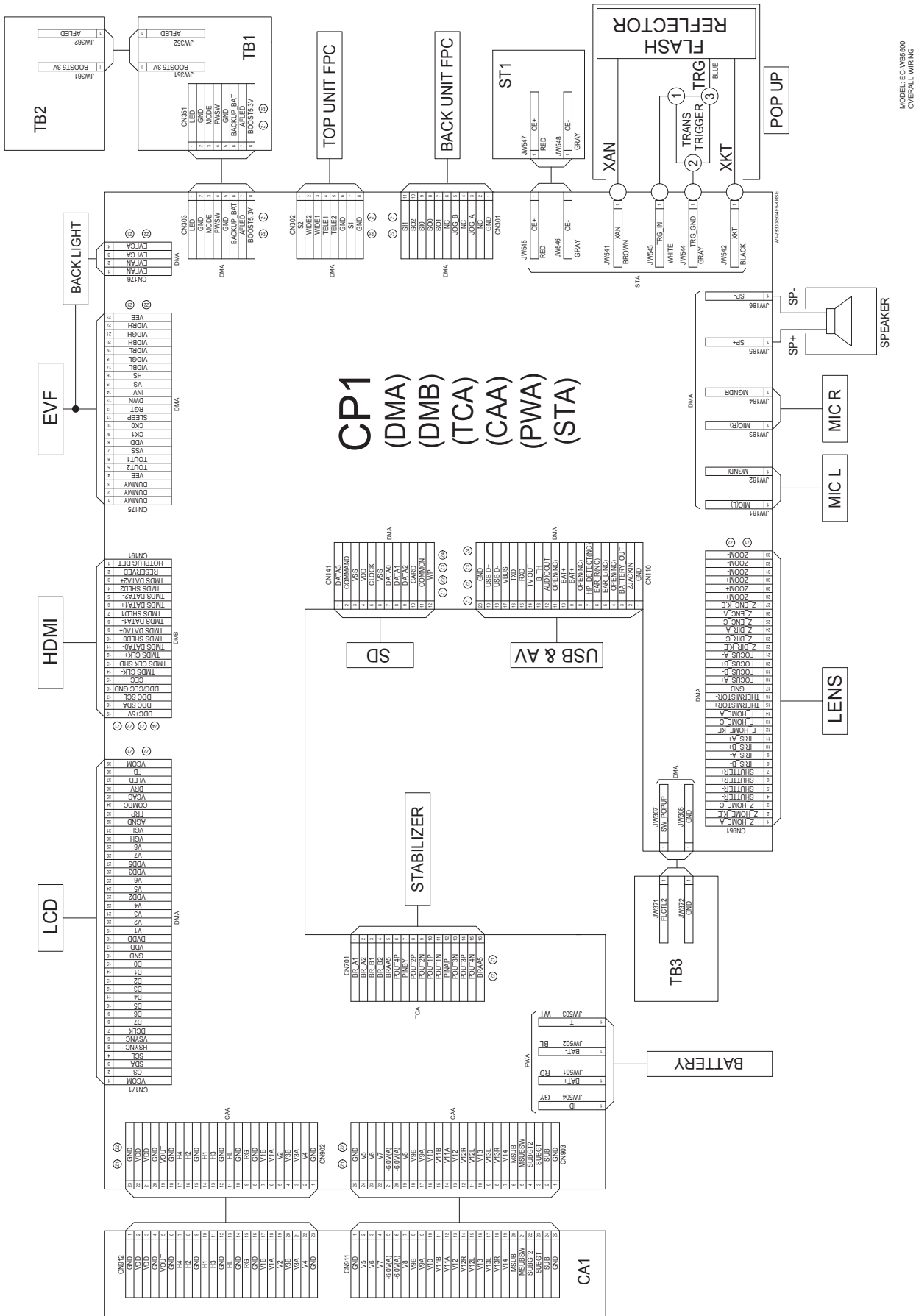

MODEL: EC-WB5500  
OVERALL WIRING